

# Fairbanks North Star Borough - Land Nominations Program

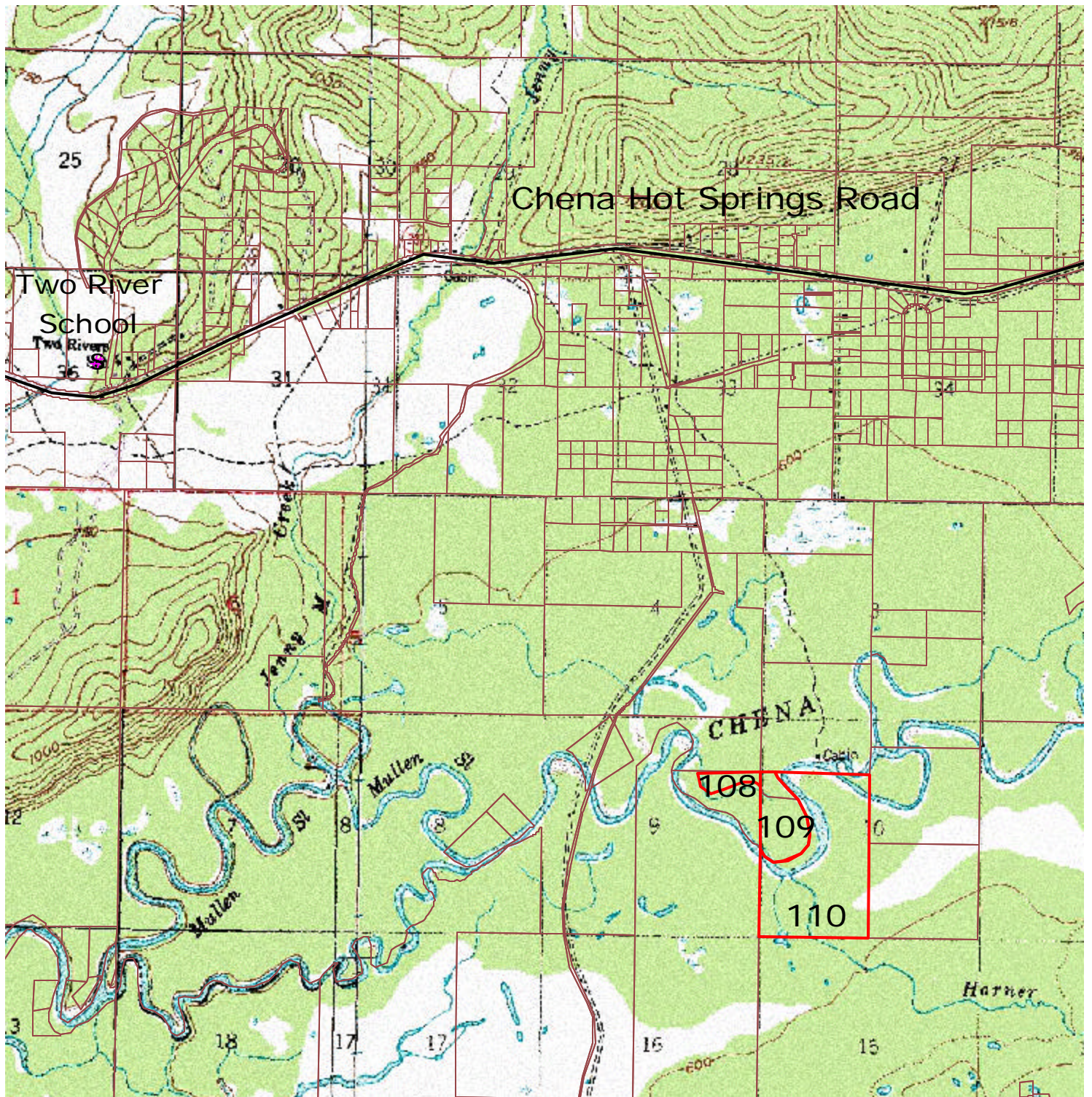

## Map 10 - Two Rivers Area Open Land



 Parcels open for Nomination

This area is river access only, approximately 2.5 miles south of mile 22 Chena Hot Springs Road.



Parcel No.: 108      Map No. 10      Map Name: Two Rivers      Title Plant Number: SE 01.04.09.

Parcel Description: S 1/2,NE 1/4 NE OF THE CHENA RIVER

**Parcel Characteristics:**

**Acreage:** 47.0

**Zoning:** GU1

**Land Status** Approved - Ta'd

**Vegetation** 100% open mixed forest-balsam poplar and white spruce -field inspection

**Elevation in ft:** 575

**Trails:**

**Wetlands:** no hydric; 100% facw?

**Comp. Plan:** Forest.

**Access** Chena River forms S & E BDY. Grange Hall Rd. is approx. .75M to NW. A trail goes from Grange Hall Rd. to parcel.

**Mining Claims:**

**% Mining:**

**Parcel Account No.** 0181480

**Nomination History**

**FNSB Permits and Licenses**

Parcel No.: 109      Map No. 10      Map Name: Two Rivers      Title Plant Number: SE 01.04.10.

Parcel Description: PTN. OF W 1/2 W1/2 SEC. 10 NORTH OF THE CHENA RIVER

**Parcel Characteristics:**

**Acreage:** 49.0

**Zoning:** GU1

**Land Status** Approved - Ta'd

**Vegetation** 100% closed mixed forest-balsam poplar and white spruce -infrared photo

**Elevation in ft:** 580

**Trails:**

**Wetlands:** no hydric; 100% facw?

**Comp. Plan:** Forest.

**Access** Grange Hall Rd. is approx. .50M to NW. Kaufman Lane is 1.25M to N. Trail leads from Grange Hall Rd to parcel. Public access ends before river because of a native allotment.

**Mining Claims:**

**% Mining:**

**Parcel Account No.** 0181480

**Nomination History**

**FNSB Permits and Licenses**

**Parcel No.:** 110

**Map No.** 10

**Map Name:** Two Rivers

**Title Plant Number:** SE 01.04.10.

**Parcel Description:** SW1/4, E1/2 NW1/4

---

**Parcel Characteristics:**

**Acreage:** 183.0

**Land Status** Approved - Ta'd

**Zoning:** GU1

**Vegetation** 100% open mixed forest-balsam poplar and white spruce -field inspection

**Elevation in ft:** 580

**Trails:**

**Wetlands:** 10% hydric; 100% facw?

**Comp. Plan:** Forest.

**Access** Grange Hall Rd. is .5M to NW. Kaufman Lane is 1.25M to N. Trail from Grange Hall Rd. goes to parcel.

**Mining Claims:**

**% Mining:**

**Parcel Account No.** 0181471

**Nomination History**

**FNSB Permits and Licenses**

---