

LEGEND	
	ENTRANCE SIGN
	RESTROOMS
	BLEACHERS
	STORAGE SHED
	PAR COURSE STATION
	PAVILION & HORSESHOE PIT
	UTILITY LINES
	NATURAL AREAS
	EASEMENT BOUNDARY
	PERIMETER FENCE
	WARMING HUT

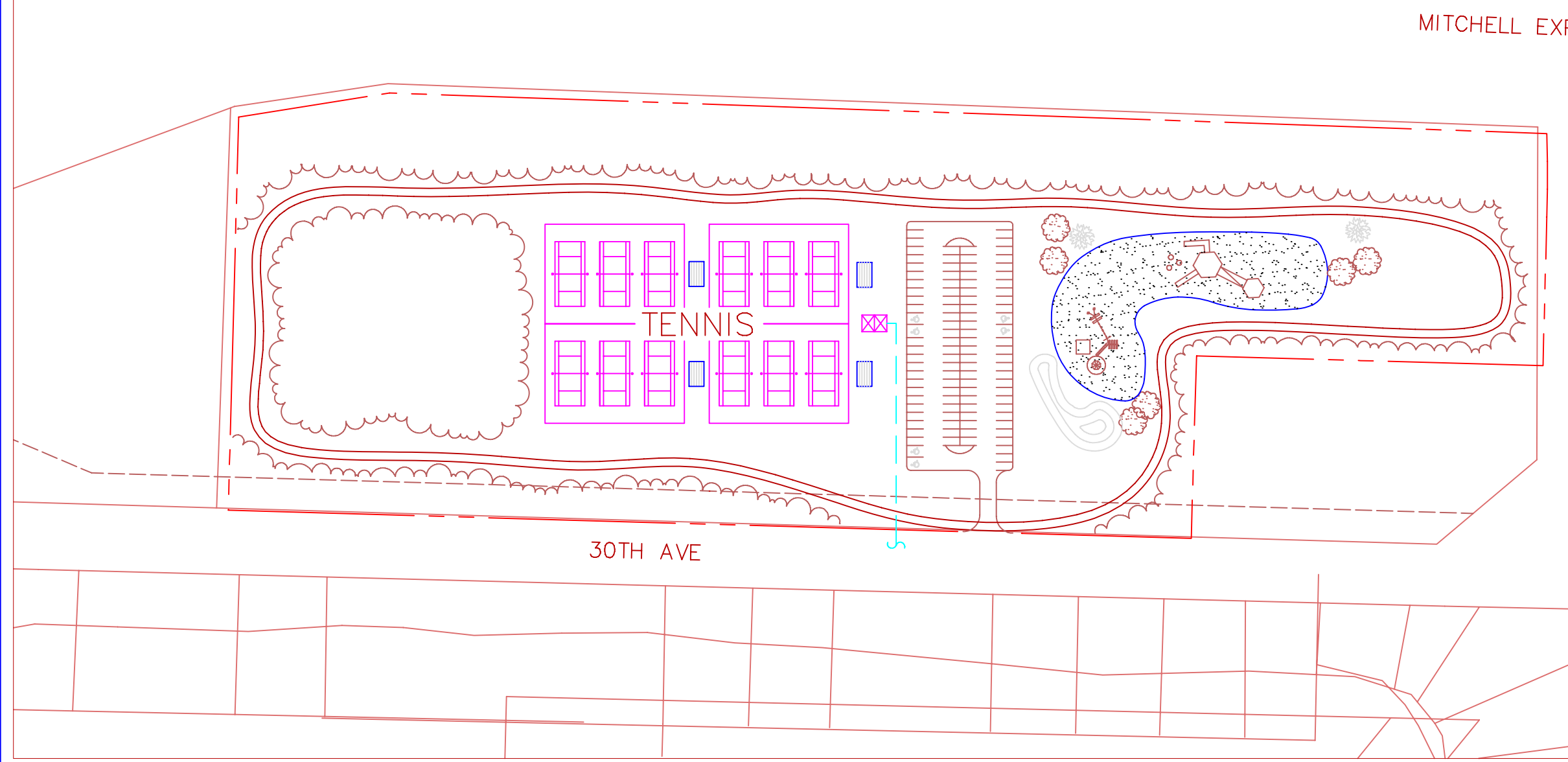

- NOTES:**
1. THE RESTROOM AND UTILITIES NEAR THE ADULT SOCCER AREA WILL ONLY BE CONSTRUCTED IF UTILITIES ARE INSTALLED ALONG DAVIS ROAD.
 2. FNSB IS PURSUING AN EASEMENT FOR THE PARK ROAD BETWEEN LATHROP STREET AND THE SLOUGH.
 3. LIGHTING IS PLANNED FOR THE ROAD, PARKING LOTS AND RESTROOM AREAS.
 4. CONCESSION AREAS ARE POSSIBLE AT FIELDHOUSES AND RESTROOM LOCATIONS.
 5. THE TRAIL PROVIDES ACCESS TO THE BIKEWAYS ON DAVIS ROAD AND LATHROP STREET.

SOUTH DAVIS PARK MASTER PLAN

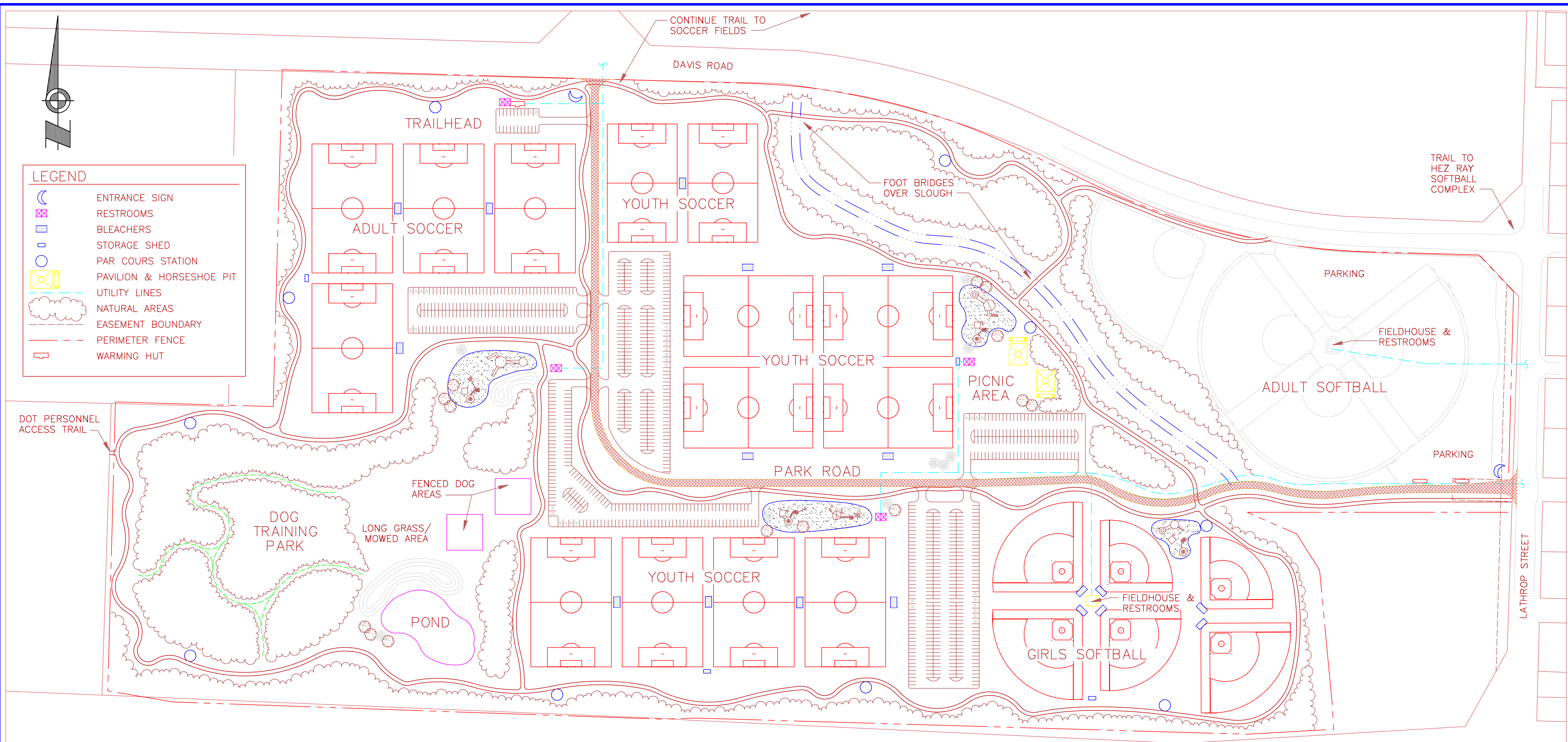
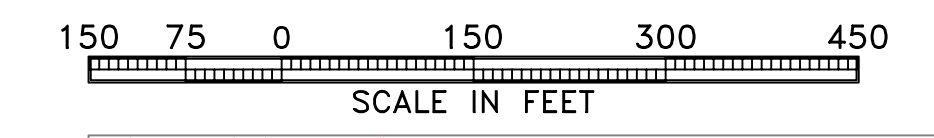

SCALE IN FEET

CONSULTANT :

PDC INC.

 Consulting Engineers

 1028 Aurora Drive, Fairbanks, Alaska 99709-5529

PROJECT : SOUTH DAVIS PARK MASTER PLAN
 FAIRBANKS, ALASKA

SHEET TITLE : SITE PLAN DRAFT

DESIGN	PAD
DRAWN	PAD/CFP
CHECKED	RLC
DATE	JUNE 1999

PROJECT No. 981114

SHEET NUMBER 3 OF 3 SHEETS